

BS/BSS 2500 = BS/BSS 180

Inner heights=H
180 mm

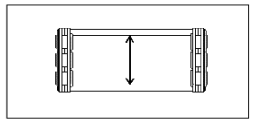

Inner widths=A
100-1300 mm

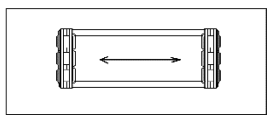

Pitch=P
250mm

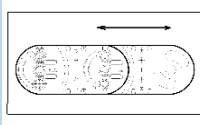

Radius=R
350-1400

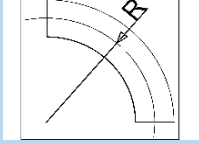

SP

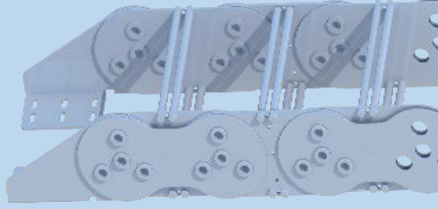
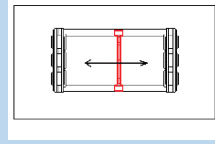

BS/BSS 1800 A

HER BAKLADA ALÜMİNYUM PROFİLTAKILI

SINGLE ALUMINUM FRAME FITTING IN EACH LINK

İÇ VE DIŞ ÇTALAR SÖKÜLEBİLİR

DETACHABLE FRAMES

AYARLANABİLİR METAL SEPERATÖR

ADJUSTABLE STEEL SEPERATORS PREVENT

KABLO TEMASLARI ÖNLENİR

INTERNAL FRICTION AND TOUCHING



BS/BSS 1800 B (LG)

ZİNCİR BOYUNCA OPTİMUM KABLO YÖNLENDİRME
KABLOYU HASAS SARAR VE KESMEZ

OPTIMUM WIRE ROUTING CABLE
DURING THE CHAIN

ÇİVATA BİRLEŞTİRMELİ SÖKÜLEBİLİR

ASSEMBLED WITH BOLT, DETACHBLE

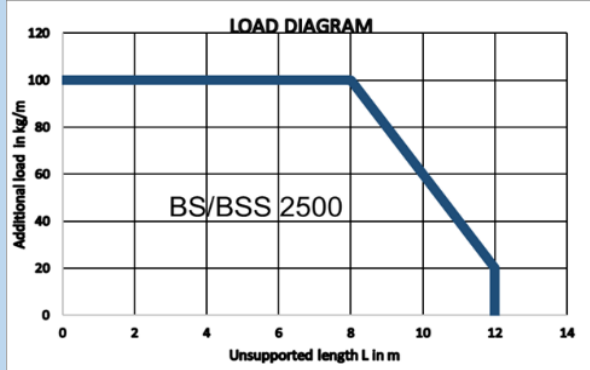
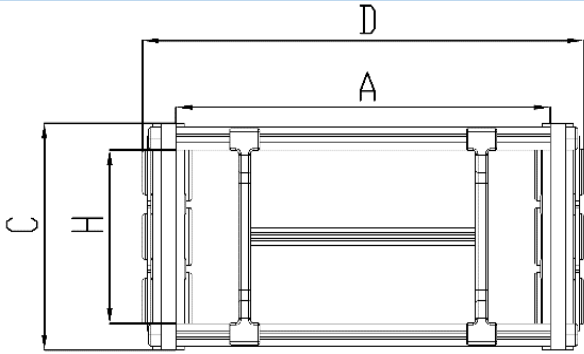

ÜRÜN KODU	H=İÇ YÜKSEKLİK	A=İÇ GENİŞLİK	C=DIŞ YÜKSEKLİK	D= DIŞ GENİŞLİK	R=KIVRILMA YARIÇAPI
PRODUCT CODE	INNER HEIGHT	INNER WEIGHT	OUTER HEIGHT	OUTER WEIGHT	BENDING RADIUS
SS 2500 = BS/BSS	180 mm	100-1300 mm	216	A+34 mm	350-1400

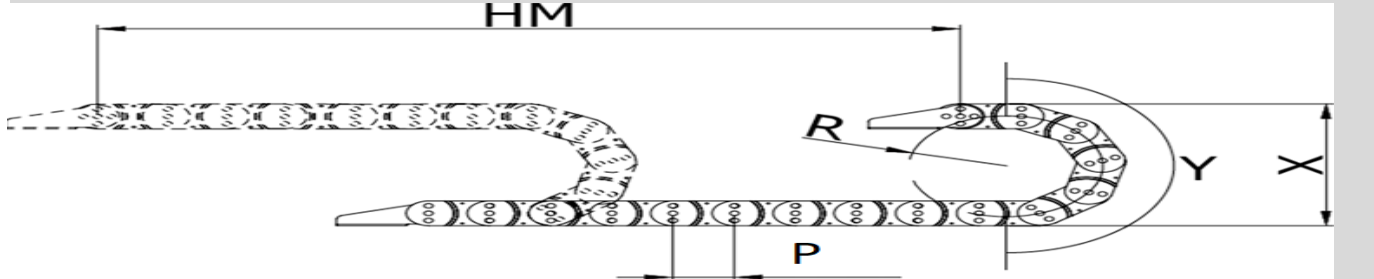

L= KULANILACAK MİKTAR	HM= HAREKET MESAFESİ	X= MONTAJ YÜKSEKLİĞİ	P= HATVE	Y= RADIUS MESAFESİ
CHAIN LENGHT	MOVEMENT DISTANCE	MOUNTING HEIGHT	PITCH	RADIUS DISTANCE
$L=HM/2+Y$		$Y=R/\pi$		$X=RX2+C$

ÖRNEK SİPARİŞ ORDER EXAMPLE
BS2500(BS180) A100 R350 L5000

3

ÜRÜN KODU	A= ACIK K= KAPALI B =ÖZEL İŞLEME(LG)	R=KIVRILMA YARI ÇAPI	L=ZİNCİR BOYU
PRODUCT CODE	A= OPEN K= CLOSED B =(LG)	R=BENDING RADIUS	(CHAIN LENGTH)
BS2500	A 300	R600	L=5000 mm

ÖRNEK GÖRÜNÜM SAMPLE VIEW

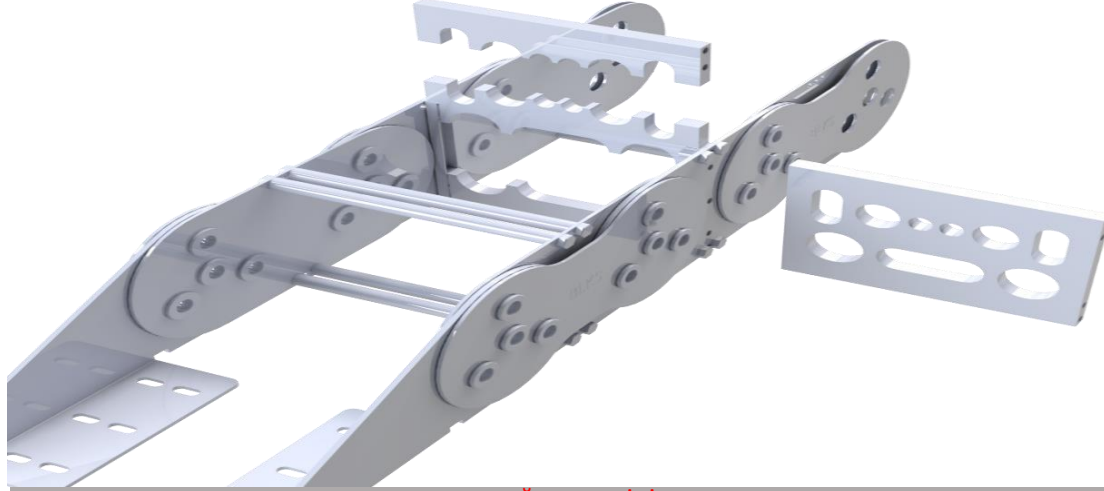

BAĞLANTI TİPİ CONNECTION TYPE

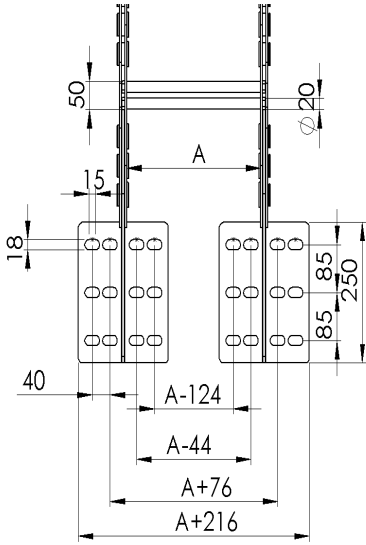

BS/BSS2500 = BS/BSS180

AYAK BAĞLANTI TİPLERİ RESİMDEKİ GİBİDİR

BASE CONNECTION TYPES AS IN THE PICTURE



SEPERATÖR SEPERATİST

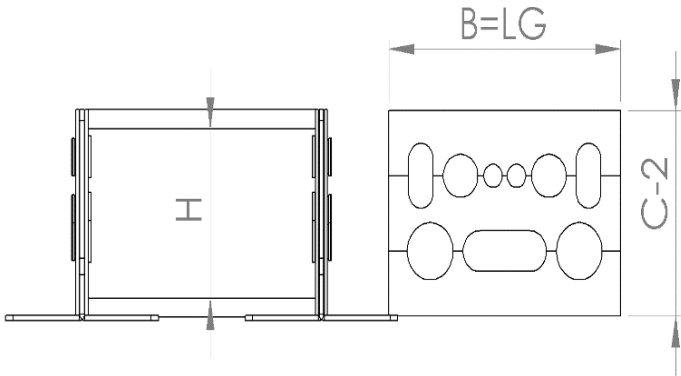

KABLO KANALI METAL SEPERATÖRLERLE BÖLÜNÜR
CABLE CHANNEL DIVIDED WITH STEEL SEPERATORS
ÇALIŞIRKEN İÇERDE SÜRTÜNMEYİ ÖNLER
prevents internal friction
YUMUŞAK DOKULU MEDYA KABLOLARI İÇİN İDEALDIR
IDEAL FOR SOFT TISSUE MEDIA CABLES