

# BS/BSS 8000

Inner heights=H  
İÇ YÜKSEKLİK

550mm

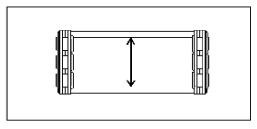

Inner widths=A  
İÇ GENİŞLİK

500-1500 mm

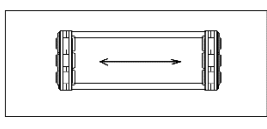

Pitch=P  
ADIM

550mm

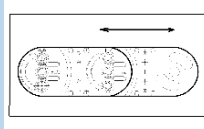

Radius=R  
KIVRILMA YARIÇAPI

900-3000

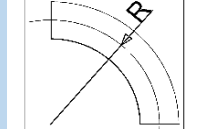

SP

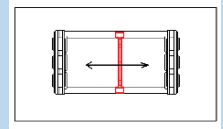

## BS/BSS 8000 A

YAN BAKLA EKSTRA BÜKÜMLE GÜÇLENDİRİLMİŞ  
HER BAKLADA BÜKÜMLÜ SAC PROFİLTAKILI  
İÇ VE DIŞ ÇTALAR SÖKÜLEBİLİR  
SABİT ALÜMİNYUM BÖLÜCÜLER  
KABLO TEMASLARI ÖNLENİR

bended -reinforced side link  
each links are connected with bended steel  
inner and outer frames  
FIXED ALUMINUM SEPARATORS  
cable contact is prevented

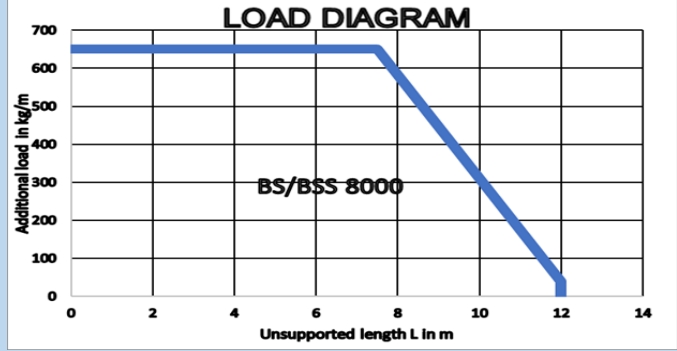
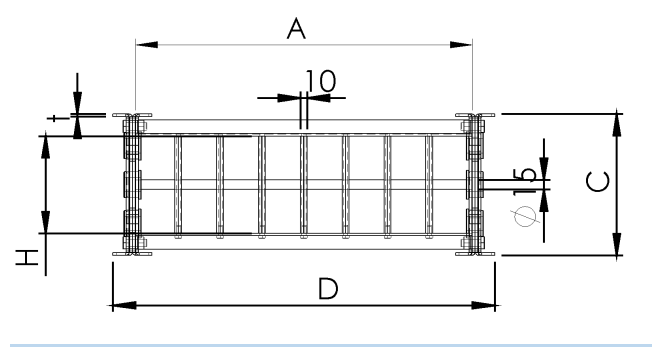
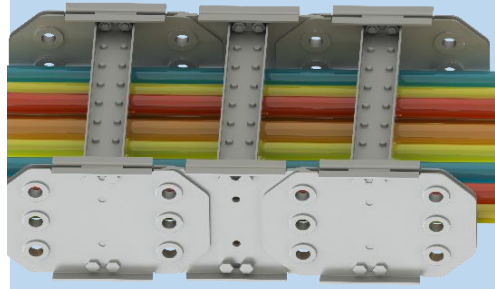

ÜRÜN KODU	H=İÇ YÜKSEKLİK	A=İÇ GENİŞLİK	C=DIŞ YÜKSEKLİK	D= DIŞ GENİŞLİK	R=KIVRILMA YARIÇAPI
PRODUCT CODE	INNER HEIGHT	INNER WIDTH	OUTER HEIGHT	OUTER WIDTH	BENDING RADIUS
BS/BSS 8000	550mm	500-1500 mm	618	A+66 mm	900-3000

ORNEK SIPARIŞ	BS8000 A250 R500 L5000	
ÜRÜN KODU	A= ACIK B =ÖZEL İŞLEME(LG)	R=KIVRILMA YARI ÇAPI
PRODUCT CODE	A= OPEN B =(LG)	R=BENDING RADIUS
BS8000	A 500	R900

L=zincir BOYU (CHAIN LENGTH)
L=5000 mm

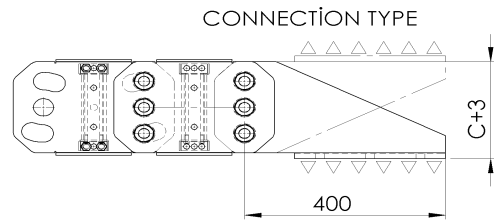
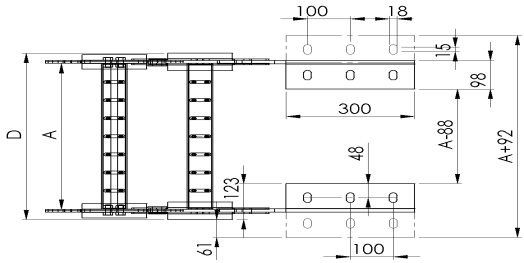

L= KULANILACAK MİKTAR	HM= HAREKET MESAFESİ	X= MONTAJ YÜKSEKLİĞİ	P= HATVE	Y= RADIUS MESAFESİ
CHAIN LENGHT	MOVEMENT DISTANCE	MOUNTING HEIGHT	PITCH	RADIUS DISTANCE
$L=HM/2+Y$		$Y=R/\pi$		$X=RX2+C$