

# S80 A SERİSİ

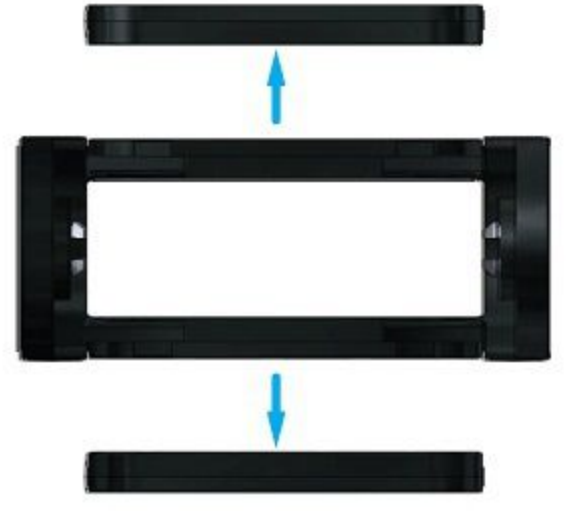
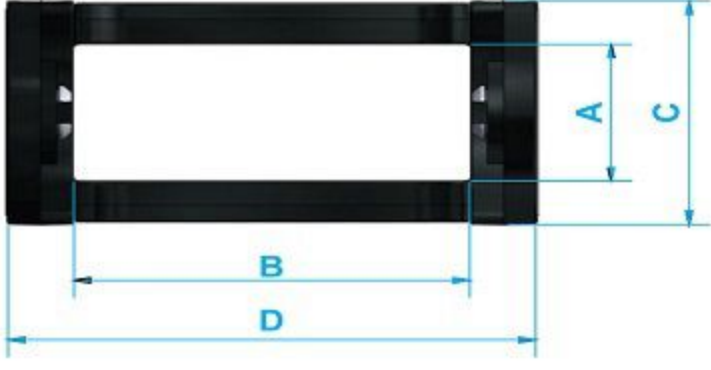

## Malzeme Özellikleri

PA 6 %30 Cam Elyafı Prime  
Çalışma Ortam Sıcaklığı  
(-30 °C +130 °C)

## Material Properties

PA 6 %30 Fiber Glass Prime  
Operating Temperature  
(-30 °C +130 °C)

Ürün Kodu Product Code	A İç Yükseklik Inner Height	B İç Genişlik Inner Weight	C Dış Yükseklik Outer Height	D Dış Genişlik Outer Weight	R Kıvrılma Yarıçapı Bending Radius	W Ağırlık kg/m Weight Kg/mt
S 80 A 080 R...	80	80	102	112	200-300	3,32
S 80 A 100 R...	80	100	102	132	200-300	3,40
S 80 A 125 R...	80	125	102	157	200-300	3,49
<b>S 80 A 150 R...</b>	<b>80</b>	<b>150</b>	<b>102</b>	<b>182</b>	<b>200-300</b>	<b>3,59</b>
S 80 A 175 R...	80	175	102	207	200-300	3,67
S 80 A 200 R...	80	200	102	232	200-300	3,73

## ÖRNEK KODLAMA / SAMPLE CODING

S80	A	200	R300
İç Yükseklik Inner Height	Açık Seri Open Desing	İç Genişlik Inner Weight	Kıvrılma Yarıçapı Bending Radius

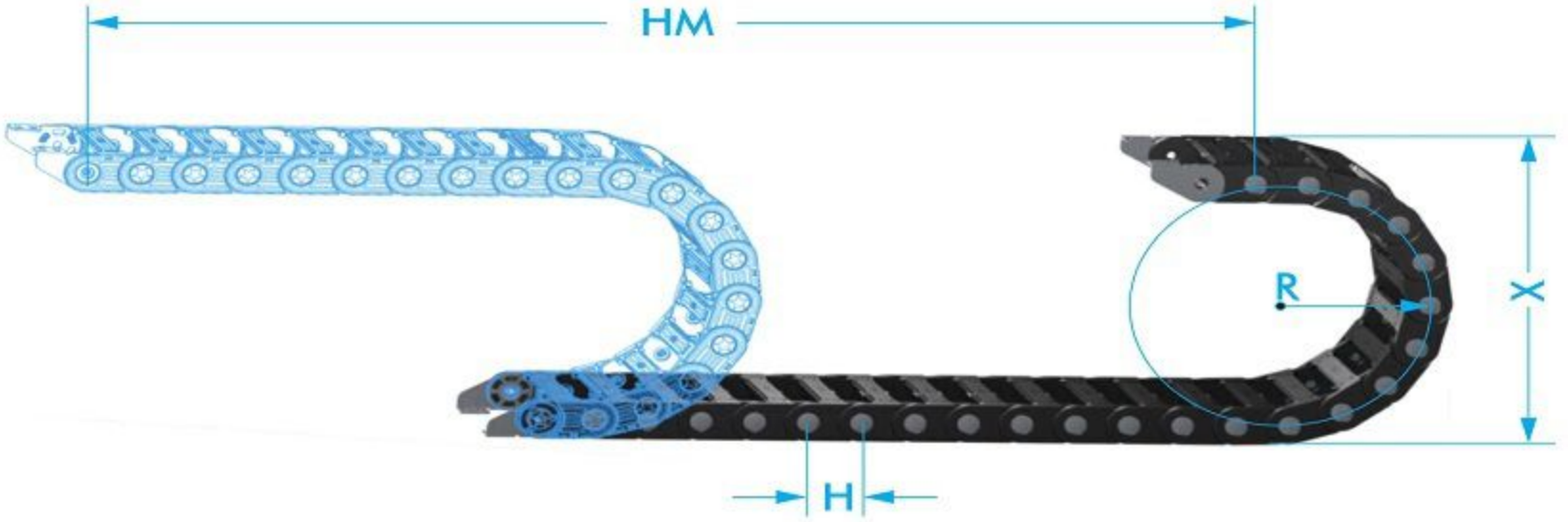
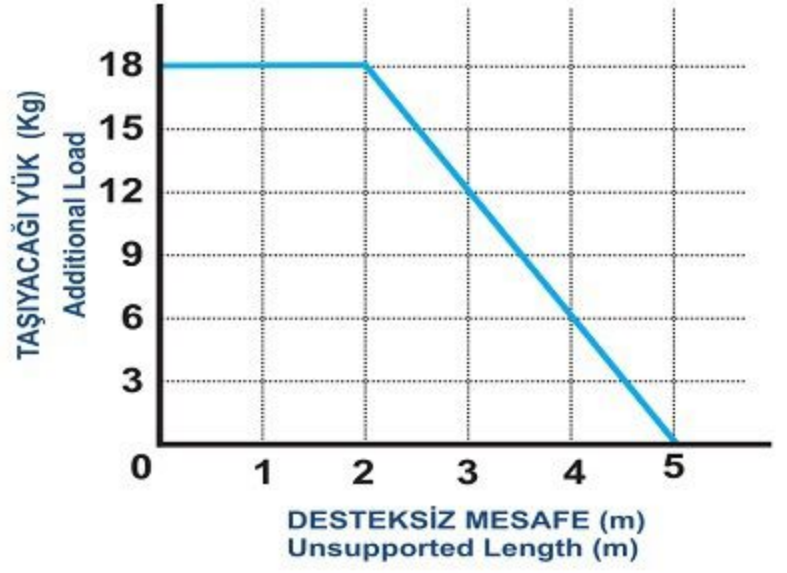

Montaj Yüksekliği  
Mounting Height  
 $X = R \times 2 + C$

Radüs Mesafesi  
Distance Radius  
 $Y = R \times \pi$

$$L = HM/2 + Y$$

R (mm)	H (mm)	X (mm)	Y (mm)
200	125	500	628
300	125	700	942

- L** Kullanılacak Miktar / Calculation of the chain length
- HM** Hareket Mesafesi / Movement Distance
- Y** Radüs Mesafesi / Radius Distance
- X** Montaj Yüksekliği / Mounting Height
- H** Hatve / Pitch

## AYAK BAĞLANTI ÖLÇÜLERİ END BRACKETED DIMENSIONS



SERİ	K	M	L	N
S80 A 080	53	68	36	11
S80 A 100	73	88	36	11
S80 A 125	98	113	36	11
<b>S80 A 150</b>	<b>123</b>	<b>138</b>	<b>36</b>	<b>11</b>
S80 A 175	148	163	36	11
S80 A 200	173	188	36	11