

S42 A SERİSİ

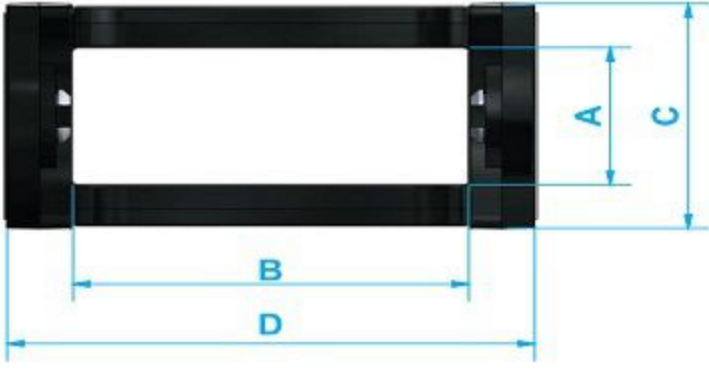

Malzeme Özellikleri

PA 6 %30 Cam Elyafı Prime
Çalışma Ortam Sıcaklığı
(-30 °C +130 °C)

Material Properties

PA 6 %30 Fiber Glass Prime
Operating Temperature
(-30 °C +130 °C)

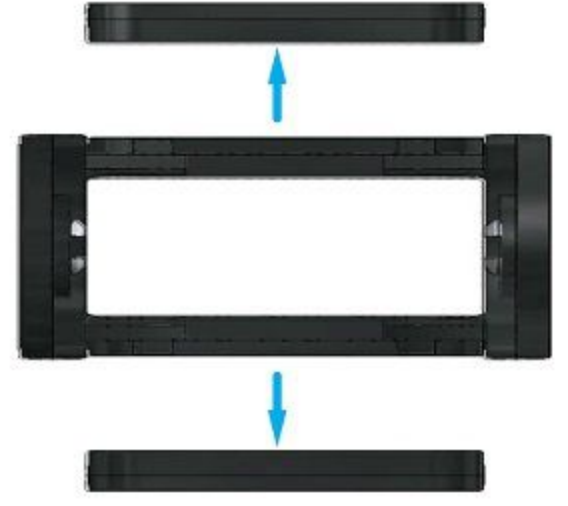

Ürün Kodu Product Code	A İç Yükseklik Inner Height	B İç Genişlik Inner Width	C Dış Yükseklik Outer Height	D Dış Genişlik Outer Width	R Kıvrılma Yarıçapı Bending Radius	W Ağırlık kg/m Weight Kg/mt
S 42 A 040 R...	42	40	58	63	75-100-150-200	1,71
S 42 A 050 R...	42	50	58	73	75-100-150-200	1,77
S 42 A 060 R...	42	60	58	83	75-100-150-200	1,83
S 42 A 080 R...	42	80	58	103	75-100-150-200	1,97
S 42 A 100 R...	42	100	58	123	75-100-150-200	2,11

ÖRNEK KODLAMA / SAMPLE CODING

S42	A	100	R200
İç Yükseklik Inner Height	Açık Seri Open Desing	İç Genişlik Inner Width	Kıvrılma Yarıçapı Bending Radius

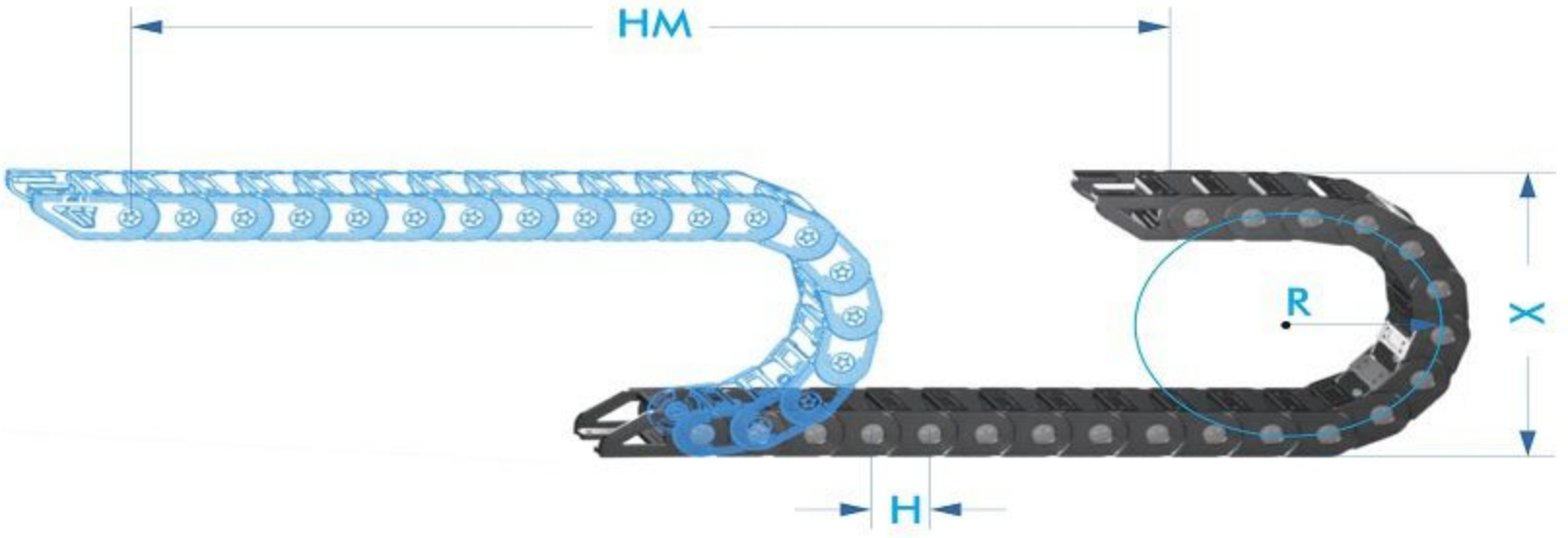
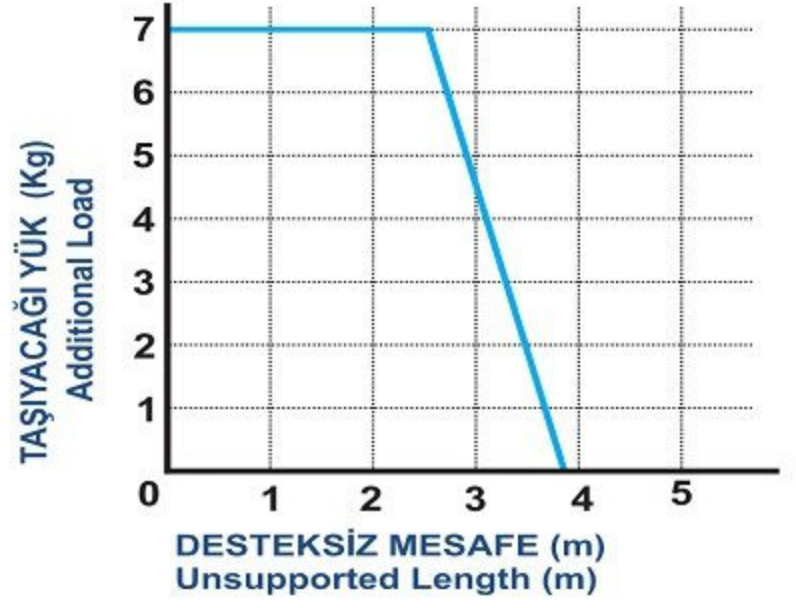

Montaj Yüksekliği
Mounting Height
 $X=R \times 2 + C$

Radüs Mesafesi
Distance Radius
 $Y=R \times \pi$

$$L = HM/2 + Y$$

R (mm)	H (mm)	X (mm)	Y (mm)
75	63	208	235,5
100	63	258	314,0
150	63	358	471,0
200	63	458	628,0

- L** Kullanılacak Miktar / Calculation of the chain lenght
- HM** Hareket Mesafesi / Movement Distance
- Y** Radüs Mesafesi / Radius Distance
- X** Montaj Yüksekliği / Mounting Height
- H** Hatve / Pitch

AYAK BAĞLANTI ÖLÇÜLERİ END BRACKETED DIMENSIONS



SERİ	K	M	L	N
S42 A 040	24	24	24	6,5
S42 A 050	34	34	24	6,5
S42 A 060	44	44	24	6,5
S42 A 080	64	64	24	6,5
S42 A 100	84	84	24	6,5