

S40 A SERİSİ

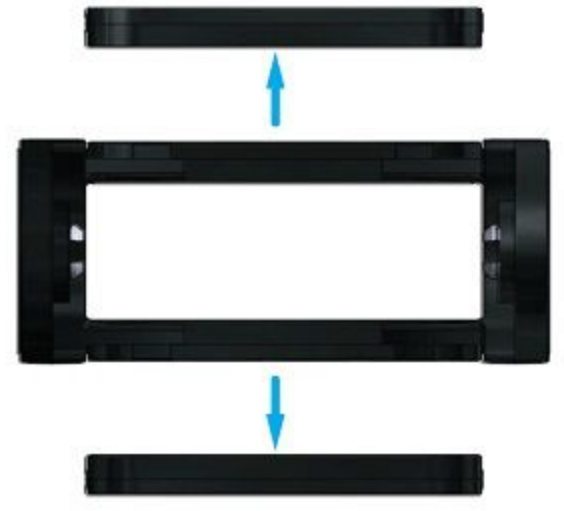
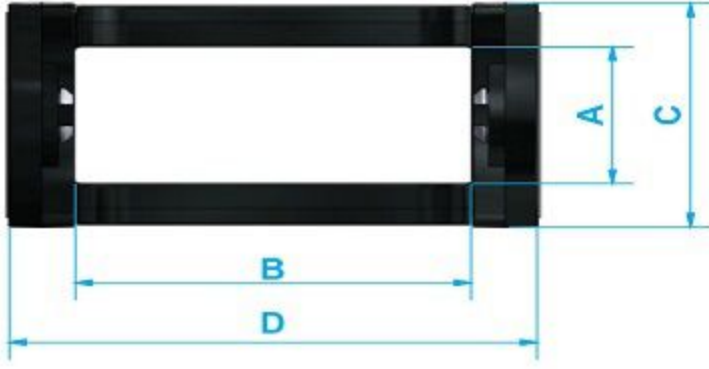

Malzeme Özellikleri

PA 6 %30 Cam Elyafı Prime
Çalışma Ortam Sıcaklığı
(-30 °C +130 °C)

Material Properties

PA 6 %30 Fiber Glass Prime
Operating Temperature
(-30 °C +130 °C)

| Ürün Kodu Product Code | A İç Yükseklik Inner Height | B İç Genişlik Inner Weight | C Dış Yükseklik Outer Height | D Dış Genişlik Outer Weight | R Kıvrılma Yarıçapı Bending Radius | W Ağırlık kg/m Weight Kg/mt |
|---------------------------|-----------------------------------|----------------------------------|------------------------------------|-----------------------------------|--|-----------------------------------|
| S 40 A 080 R... | 40 | 80 | 62 | 108 | 75-100-150-200 | 2,39 |
| S 40 A 100 R... | 40 | 100 | 62 | 128 | 75-100-150-200 | 2,53 |
| S 40 A 125 R... | 40 | 125 | 62 | 153 | 75-100-150-200 | 2,70 |
| S 40 A 150 R... | 40 | 150 | 62 | 178 | 75-100-150-200 | 2,87 |
| S 40 A 175 R... | 40 | 175 | 62 | 203 | 75-100-150-200 | 3,01 |
| S 40 A 200 R... | 40 | 200 | 62 | 228 | 75-100-150-200 | 3,12 |

ÖRNEK KODLAMA / SAMPLE CODING

| S40 | A | 125 | R150 |
|------------------------------|--------------------------|-----------------------------|-------------------------------------|
| İç Yükseklik Inner Height | Açık Seri Open Desing | İç Genişlik Inner Weight | Kıvrılma Yarıçapı Bending Radius |

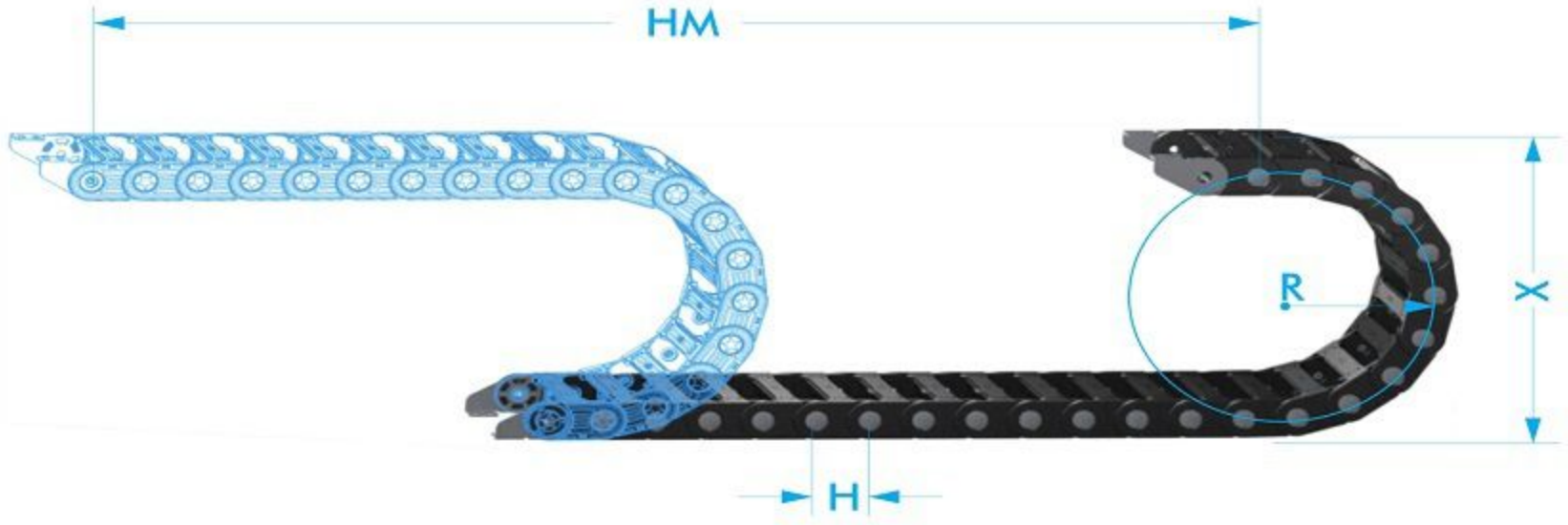
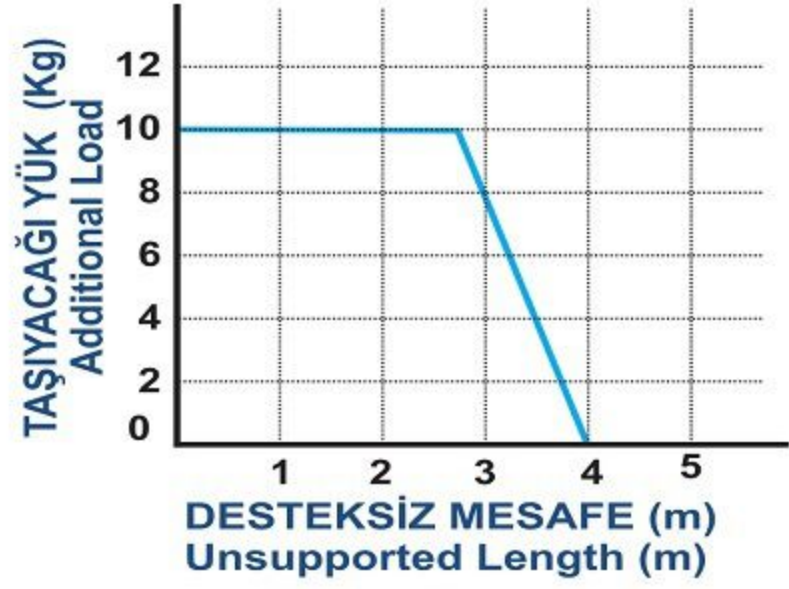

Montaj Yüksekliği
Mounting Height
 $X = R \times 2 + C$

Radüs Masefesi
Distance Radius
 $Y = R \times \pi$

$$L = HM/2 + Y$$

| R (mm) | H (mm) | X (mm) | Y (mm) |
|--------|--------|--------|--------|
| 75 | 71,50 | 210 | 233,50 |
| 100 | 71,50 | 260 | 314,00 |
| 150 | 71,50 | 360 | 471,00 |
| 200 | 71,50 | 460 | 628,00 |

- L** Kullanılacak Miktar / Calculation of the chain lenght
- HM** Hareket Mesafesi / Movement Distance
- Y** Radüs Mesafesi / Radius Distance
- X** Montaj Yüksekliği / Mounting Height
- H** Hatve / Pitch

AYAK BAĞLANTI ÖLÇÜLERİ END BRACKETED DIMENSIONS



| SERİ | K | M | L | N |
|-----------|-----|-----|----|---|
| S40 A 080 | 56 | 62 | 20 | 9 |
| S40 A 100 | 76 | 82 | 20 | 9 |
| S40 A 125 | 101 | 107 | 20 | 9 |
| S40 A 150 | 126 | 132 | 20 | 9 |
| S40 A 175 | 151 | 157 | 20 | 9 |
| S40 A 200 | 176 | 182 | 20 | 9 |